

0m 1m 2m 3m

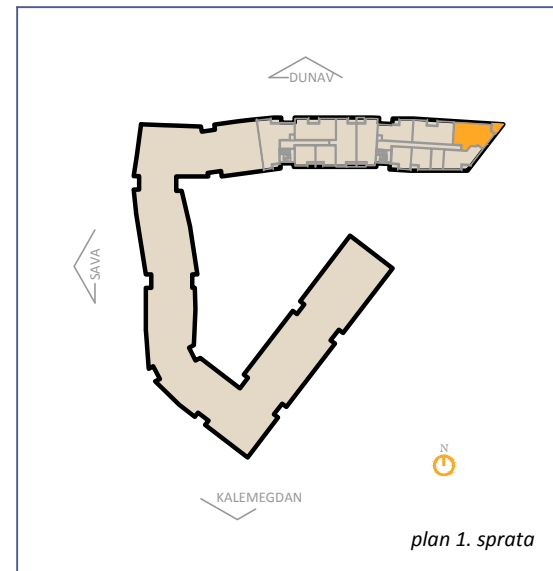

POVRŠINA STANA 107.63m<sup>2</sup>  
APARTMENT AREA

POVRŠINA TERASA 8.66m<sup>2</sup>  
TERRACE AREA

UKUPNA POVRŠINA 116.30m<sup>2</sup>  
TOTAL AREA

12.1.4

12.2.4

12.3.4

12.4.4

ČETVOROSOBAN STAN